

# MAGiC PHiR SE

YOUR SECOND CHANCE TO

अनंतam LIFE



# SUCCESS OF ANANTAM

In 2018, Regency Group unveiled its ground-breaking project, Anantam, which swiftly captured the attention of the real estate market. Anantam proved to be an instant sensation, with its launch inventory selling out within a mere month of its launch. The project's unprecedented success was nothing short of magical, leaving potential buyers astounded as they witnessed the rapid depletion of available units.

Anantam distinguished itself in the real estate landscape by offering an unparalleled blend of luxury and convenience. Boasting expansive acres of land parcel, the project emerged as a towering figure in the market, redefining the standards of modern living. Its meticulously curated amenities further elevated its appeal, promising residents an unmatched lifestyle experience.

Despite the overwhelming demand, many aspiring homeowners were left in awe as they found themselves unable to secure a coveted spot within Anantam. The project's swift sell-out underscored its status as a sought-after gem in the realm of real estate, leaving a lasting impression on the industry and cementing its legacy as a true market leader.





A woman with dark hair, wearing a white shirt and pink pants, sits on the edge of a bed, reading a book. A young girl with dark hair, wearing a white shirt, sits on the floor looking up at the book. A stream of golden light particles flows from the book towards the girl. The room is dimly lit by a floor lamp and a window showing a night sky with a full moon. A large teddy bear sits on the floor next to the girl. The background features a white brick wall and a wooden wardrobe.

# MAGIC PHIR SE,

*An exciting opportunity emerges for those who missed their chance with Regency Anantam. This isn't just another housing project; it's a gateway to a life of elegance and exclusivity. Building upon the legacy of its predecessor, this development promises to reignite the excitement and anticipation that defined the earlier project, offering a fresh chance to embrace luxury living and convenience. For those yearning to be part of this prestigious community, it's a second chance to fulfill dreams and aspirations, to create a home in a setting crafted for elegance and exclusivity.*

*This magical opportunity serves as a beacon of hope, providing a fresh opportunity to become part of this esteemed community. As the curtains rise on this new chapter, it stands poised to captivate hearts and minds once again, ushering in a new era of unparalleled living experiences in the real estate market.*



PRESENTING





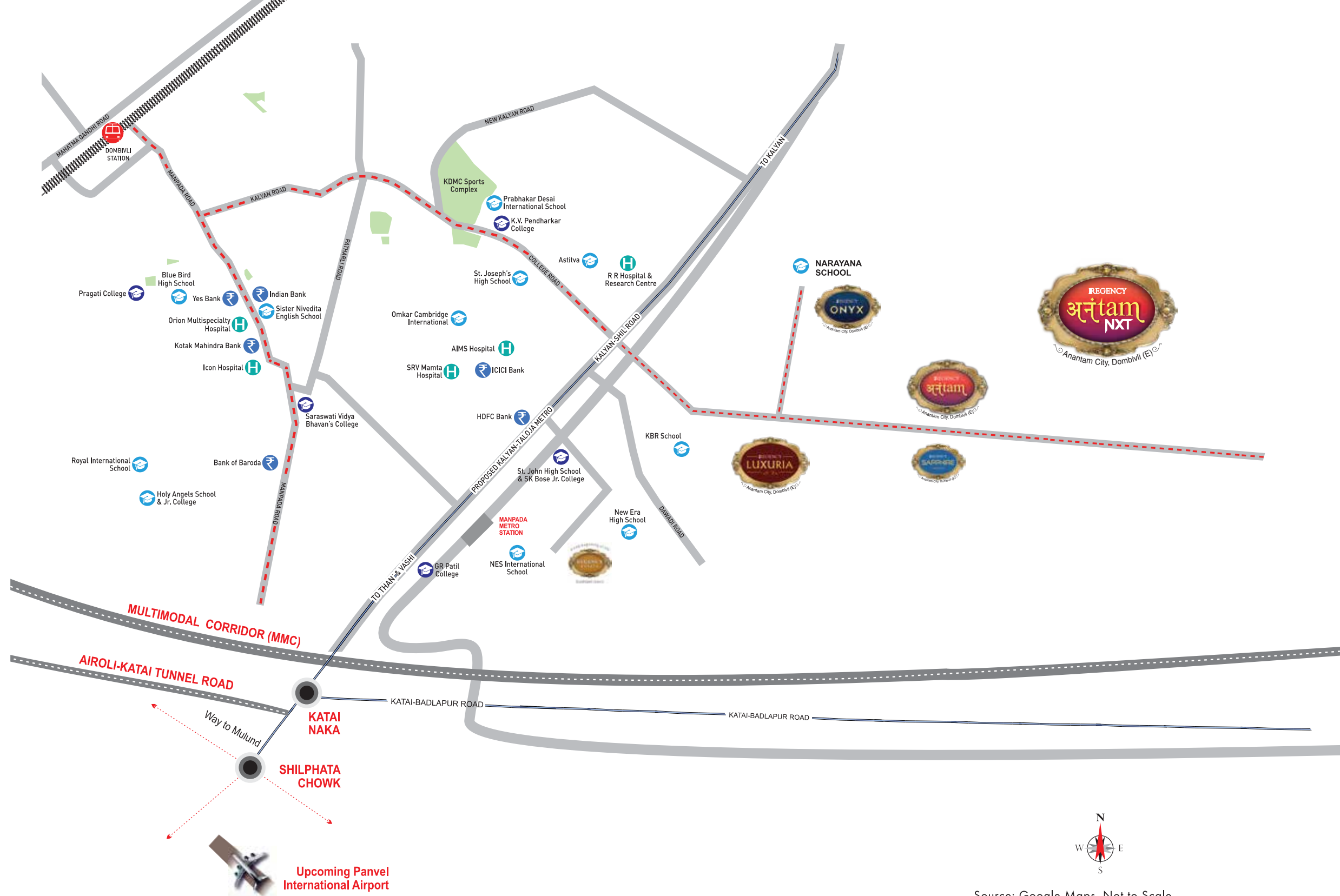

Source: Google Maps. Not to Scale.

# NXT Level CONNECTIVITY

Anantam's unparalleled connectivity not only contributed to its rapid sales but also cemented its status as a resounding success. The project's connectivity acted as a magnet for discerning homebuyers, who recognized the inherent value of residing in a location that seamlessly connected them to vital destinations. This strategic advantage, coupled with its luxurious amenities and commitment to quality, led to the project being swiftly sold out.

Dombivli, strategically positioned with easy connectivity to Navi Mumbai, Airoli, and Thane, emerges as a vibrant urban center primed for growth. With upcoming infrastructure like the Kalyan-Taloja Metro Line and the Panvel Airport, its allure for both residential and commercial endeavors is undeniable.





# NXT Level CLUBHOUSE

Makers of extraordinary experiences





Actual Image

## MINI THEATRE



Actual Image

## HAIR & BEAUTY SALON

## BADMINTON COURT



Stock Image

## GYMNASIUM



Actual Image





# **NXT** Level **AMENiTiES**

Makers of extraordinary experiences





Artist's Impression

## MULTI-PURPOSE COURTS



Artist's Impression

## CHILDREN'S PLAY AREA

## JOGGING TRACK



Artist's Impression

## GAZEBO SIT-OUT



Artist's Impression





# PROJECT LAYOUT



1 BHK FLOOR PLAN



RERA CARPET AREA IN SQ.MTS	BALCONY AREA	RERA CARPET AREA IN SQ.FTS	BALCONY AREA
39.78 sq.mt	7.49 sq.mt	428 sq.ft	80.60 sq.ft

1 BHK UNIT PLAN





2 BHK FLOOR PLAN



RERA CARPET AREA IN SQ.MTS	BALCONY AREA	RERA CARPET AREA IN SQ.FTS	BALCONY AREA
61.16 sq.mt	10.52 sq.mt	658 sq.ft	113 sq.ft

RERA CARPET AREA IN SQ.MTS	BALCONY AREA	RERA CARPET AREA IN SQ.FTS	BALCONY AREA
59.60 sq.mt	10.52 sq.mt	642 sq.ft	113 sq.ft

2 BHK UNIT PLAN





UNPARALLELED COMFORT  
BIGGEST TOWNSHIP  
GATED COMMUNITY  
MODERN AMENITIES  
TRUST EVOLVED LUXURIES  
EXPANSIVE  
WHY REGENCY?  
REMARKABLE  
TIMELY DELIVERY  
CONNECTIVITY  
QUALITY CONSTRUCTION

ICONIC LANDMARKS, OUR BRAND'S LEGACY



Regency Willows



Regency Crest



Regency Antilla



Regency Avana



Regency Sarvam



Regency Classic



Regency Meadows



Regency Icon



Regency Ellanza



Regency Anantam



## A C C O M P L I S H M E N T S   &   A C C O L A D E S







Site Address: Regency Anantam City, KalyanShil Road, Vicco Naka, Dombivli (E) - 421 203

Corporate Address: Regency Nirman Limited, Regency House, Near Aman Talkies, Ulhasnagar - 421 002



Regency Anantam NXT registered via MahaRERA Reg. No.: P51700055848 (Phase - I) available on website - <https://maharera.mahaonline.gov.in> under registered projects.

All transactions in this development shall be subject to and governed by the terms and conditions of the Agreement for Sale to be entered into between the parties. \*T & C Apply. Disclaimer: All the images, pictorials, visuals, elevations, perspectives, illustrations, model, specifications, plans, designs, drawings, dimensions, maps, facilities, amenities, features, and other information/details herein are conceptual, indicative and for representation purpose only and are not to scale, and is subject to the approval of the respective authorities. The Promoters/Developers/Architect reserve the right to add, alter, delete or replace any of these in the interest of the development, without any notice or obligation. This printed material does not constitute an offer or contract of any nature whatsoever between the Promoters/Developers and the recipient. All transactions in this development shall be subject to and governed by the terms & conditions of the Agreement for Sale to be entered into between the parties.